

# Bedrock Geologic Map of the Colwell (Iowa) 7.5' Quadrangle

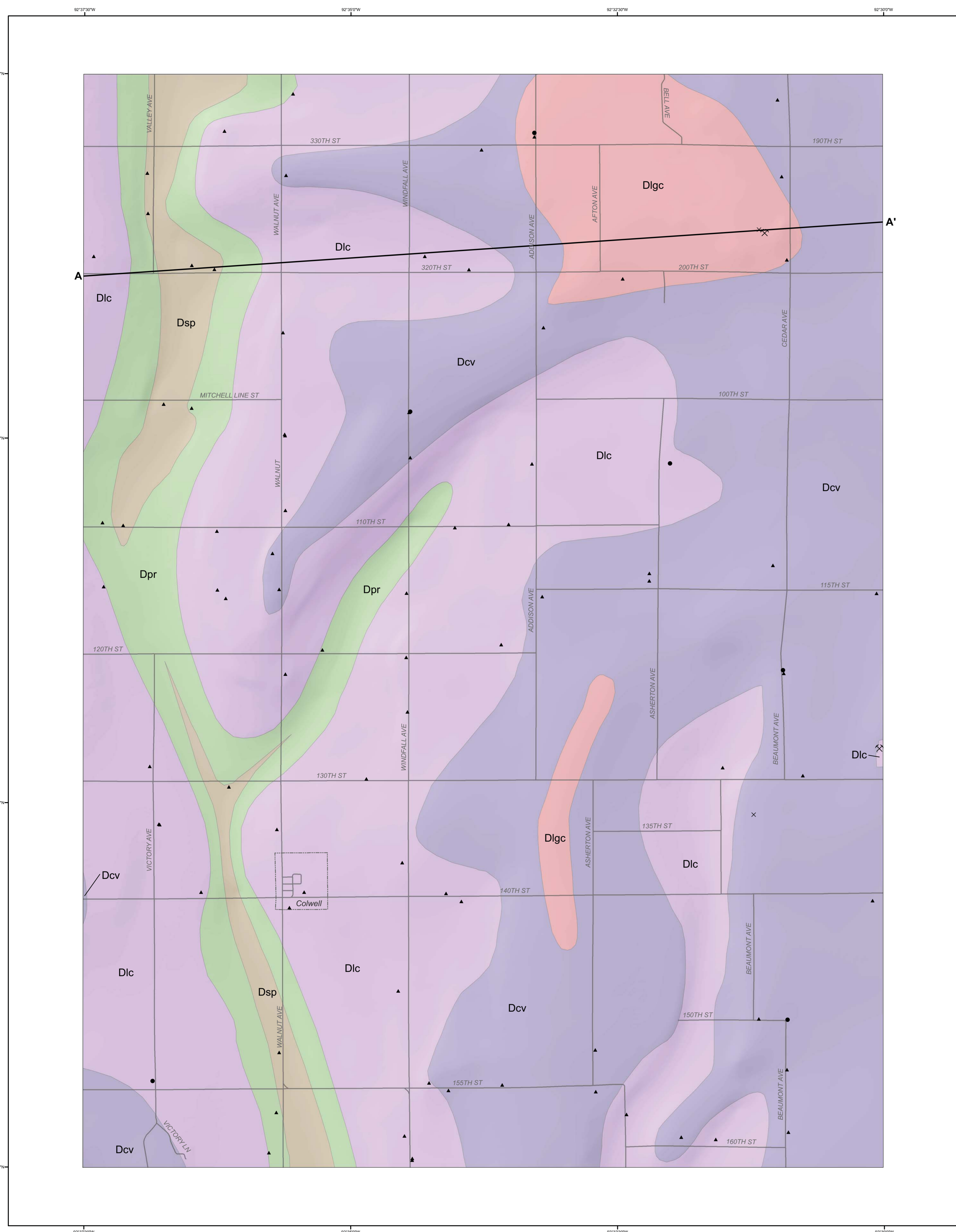

**LEGEND**

**CENOZOIC**

**QUATERNARY SYSTEM**

**Qu** - Unconsolidated Unconsolidated Sediments (Quaternary System). The Quaternary deposits consist of loess, glacial till, and colluvium of variable thickness, and alluvial clay, silt, sand, and gravel. The Quaternary deposits cover almost all the mapping area with a thickness commonly more than 10 m (30 ft) and can be thicker than 60 m (200 ft) in a deep bedrock valley throughout the western part of the quadrangle. This unit is shown only on the cross-section, not on the map.

**PALEOZOIC**

**DEVONIAN SYSTEM**

**Dgc** - Limestone, Dolomite, and Shale (Lithograph City Formation) Middle Devonian. This unit still mostly occurs on the bedrock surface in the northern part of the quadrangle. The original thickness of this unit is around 21 to 39 m (70-130 ft), but it is now less than 10 m (30 ft) in the mapping area because of erosion. This unit consists of limestone, dolomite, limestone, dolomite, and minor shale. It is usually characterized by interbedded lithographic and sub-lithographic limestone and dolomite. Limestone, in part argillaceous, "blocky" structures, vugs and calcite vugs fills are common. Some intervals are fossiliferous and arenaceous.

**Dcv** - Limestone and Dolomite (Coralville Formation) Middle Devonian. This unit occurs at the bedrock surface in the east part and the southern corner of the quadrangle. The thickness of this unit varies between 12 and 21 m (40-70 ft) in the mapping area. It consists of limestone, dolomite limestone, and dolomite, in part laminated, argillaceous, or shaly. Brecciated, calcareous dolomite, and brecciated argillaceous dolomite are especially abundant in the lower portion.

**Dlc** - Dolomite, Limestone, and Shale (Little Cedar Formation) Middle Devonian. This unit occurs at the bedrock surface of the west part beyond the deep bedrock valley of the quadrangle. The thickness of this unit varies from 6 to 14 m (20-45 ft). Compared to other Devonian units in the mapping area, this formation is usually unfossiliferous.

**Dpr** - Dolomite and Dolomitic Limestone (Pinicon Ridge Formation) Middle Devonian. This unit occurs at the bedrock surface along the deep bedrock valley throughout the western part of the quadrangle. The formation consists of dolomite and dolomitic limestone with varying textures (shaly, laminated, brecciated, sandy, and/or shaly). The thickness of this unit varies from 6 to 14 m (20-45 ft). Compared to other Devonian units in the mapping area, this formation is usually unfossiliferous.

**Dsp** - Dolomite (Spillville Formation) Middle Devonian. This unit is dominated by medium to thick bedded dolomite with scattered abundant fossil molds, with a maximum thickness of approximately 21 m (70 ft) in the mapping area. In basal part, where present, is usually sandy, shaly, and/or conglomeratic with rounded Ordovician cherty clasts.

**OTHER FEATURES**

- New drill holes for this map project
- Bedrock outcrops
- IGS Geologic Data points - month available at [www.iowageologic.com](http://www.iowageologic.com)
- Interpreted city boundary
- Quarries
- Roads
- W56388
- With used for geologic cross-section
- Bedrock Hillshade - shades of gray show the bedrock surface as it would be illuminated by an artificial light source from the NW direction

**BEDROCK GEOLOGIC MAP OF THE COLWELL 7.5' QUADRANGLE, CHICKASAW, FLOYD, HOWARD, AND MITCHELL COUNTIES, IOWA**

Iowa Geological Survey  
Open File Map OFM-17-3  
June 2017

Huanbo Liu, Ryan Clark, Phil Kerr, and Stephanie Tassier-Sartre  
Iowa Geological Survey, IHR-Hydroscience & Engineering, University of Iowa, Iowa City, Iowa

IOWA GEOLOGICAL SURVEY

Iowa Geological Survey, Robert D. Lina, State Geologist

Supported in part by the U.S. Geological Survey, National Cooperative Geologic Mapping Program (NCGMP), National Cooperative Geologic Mapping Act (50 USC 3161), and National Cooperative Geologic Mapping Act (50 USC 3161).

**ACKNOWLEDGMENTS**

We thank Brecken Ridge Products Inc., Conoco-Phillips, and F&L R. Construction Co. for allowing us to work in their quarries in and around the mapping area. Special thanks to Shirley Kubiak, Dorothy & Tina Martin, the Marick, and Grand River for allowing access to their quarries. We thank the Iowa Geological Survey, National Cooperative Geologic Mapping Program (NCGMP), National Cooperative Geologic Mapping Act (50 USC 3161), and National Cooperative Geologic Mapping Act (50 USC 3161) for providing the Iowa geologic mapping database. Adam Schaeffer of Iowa Department of Environmental Sciences studies, providing descriptive topographic maps of water well drilling samples. Thanks also to Rick Lantz (IGS) for managing the Iowa geologic mapping database. Andrew Schaeffer of Iowa Department of Environmental Sciences, providing geologic information of some quarries in the mapping area. Jai Day of Illinois State University, Bill Bunker, Dean Witke, Robert Rowden, and Andrew Rowen of Iowa Department of Natural Resources (IDNR) provided geologic information for this bedrock geologic map. IDNR and Andrew Rowen of IHR-Hydroscience & Engineering provided GIS technical help. Administrative support was provided by Megan Delaney, Rosemary Trant, Teresa Gaffey, Ajay Rosenbaum, and Carmen Langit.

**STRATIGRAPHIC COLUMN**

System	Series	Stage	Lithostratigraphic Unit	Map Symbol	Lithology	Thickness (in feet)	
Devonian	Upper	Frasnian	Lithograph City Formation	Dgc	[Symbol]	0-20	
			Coralville Formation	Dcv	[Symbol]	40-70	
			Little Cedar Formation	Dlc	[Symbol]	80-100	
			Pinicon Ridge Formation	Dpr	[Symbol]	20-45	
			Spillville Formation	Dsp	[Symbol]	40-70	
	Middle	Givetian	Cedar Valley Group				
Lower	Eifelian	Wapsipinicon Group					

**Introduction to the Bedrock Geologic Map of the Colwell 7.5' Quadrangle, Chickasaw, Floyd, Howard, and Mitchell Counties, Iowa**

The Colwell 7.5' Quadrangle is located in the connection area of Floyd, Mitchell, Howard and Chickasaw counties in north-central Iowa. In terms of landforms, this quadrangle lies in the Iowa Surface landform region where the land surface has been modified by various episodes of erosion before and during the Wisconsin-age glacial events (Prior, 1991). Due to extensive glacial and erosional activities, the landscape of this area is characterized by relatively low topographic relief and commonly features large fieldstones of glacial origin known as glacial erratics.

The land surface of this area is mostly covered by Quaternary sediments, including loess, glacial sediments, colluvium and alluvial deposits. Thickness of the Quaternary is commonly more than 18 m (60 ft) in most of the mapping area except the far eastern portion of the quadrangle, and it reaches a maximum thickness of more than 90 m (295 ft) in a bedrock valley located in the western part of the mapping area. For the detailed Quaternary stratigraphy and distribution, see the surficial geologic map of this quadrangle (Kerr et al., 2017).

Only two rock quarries and no natural bedrock exposures are found in this quadrangle. Therefore, subsurface bedrock geologic information was mostly derived from the analysis of water well data stored in the IGS GeoScan database and the soil maps from the digital soil surveys in related counties (Bunker and Highland, 1974; Voy, 1995; Voy and Bunker, 1975; Wilson, 1996). Within the mapping area, a total of 87 private and public wells were studied including 6 new drill holes for this project. Among these wells, 49 have descriptive stratigraphies with cutting samples which are deposited at the IGS Geological Rock Library. Twenty-six of these stratigraphies were newly logged for this bedrock geologic mapping task. Bedrock stratigraphic information from the surrounding area, including bedrock outcrops, quarries, and well information, was also studied and utilized for this bedrock geologic map.

The bedrock surface of the Colwell 7.5' Quadrangle is completely occupied by the Devonian strata deposited from Eifelian through early Frasnian. Paleogeographically, the mapping area is within the northern portion of the Devonian Iowa Basin, a region of thickened shelf carbonate, shale and minor others deposited from the Eifelian through part of the Frasnian stage (Witke et al., 1988; Witke and Bunker, 2006; Day, 2006; Day et al., 2008). The Middle and lower Upper Devonian carbonate rocks form the important upper bedrock aquifer in the mapping area (Libra et al., 1984, 1994). This Devonian aquifer becomes vulnerable when it is shallow, and carbonate rocks, especially relatively pure limestones, are easily karstified (Moore, 1995). Due to its complex sedimentary lithology and depositional environments, the geology, paleoenvironments, paleontology and stratigraphy of the Devonian Iowa Basin have been intensively studied. Early studies include the publications of Belanski (1927, 1928) and Koch (1970). Recent studies of the Devonian Iowa Basin are represented by Witke and Bunker (1984), Anderson (1984), Bunker and others (1986), Bunker (1995), Anderson and Bunker (1998), Witke and others (1988), Groves and others (2008), McKay and Liu (2012), and Day and others (2006, 2008, 2013). Geologic mapping projects at 1:24,000 scale in north-central Iowa have been undertaken by the IGS since 2009. In addition to 7.5' quadrangle maps, 1:100,000 scale bedrock geologic maps have been recently completed for Bremer County (McKay et al., 2010), Worth County (Liu et al., 2012), Black Hawk County (Rowden et al., 2013), Cerro Gordo County (Liu et al., 2015), and Mitchell County (Clark et al., 2016) in the Devonian Iowa Basin. The Bedrock Geologic Map of Iowa (1:500,000) was completed by Witke and others (2010). Results from these geologic studies and bedrock geologic mapping projects provide significant regional geologic information and new data for the present bedrock map.

The bedrock surface of the map is comprised of five Devonian formations. They are (in descending order) the Lithograph City, Coralville, Little Cedar, Pinicon Ridge and Spillville formations. Among them, the carbonate Coralline and Little Cedar formations dominate most of the bedrock surface of the quadrangle, and the Pinicon Ridge and Spillville formations only occur in a deep bedrock valley throughout the western part of the mapping area. The bedrock stratigraphic nomenclature and correlation of the Devonian strata for this map follow the stratigraphic framework proposed by Witke and others (1988). The general lithologic features and thickness of each map unit are shown in the Stratigraphic Column and described in the Legend section of this map.

**References:**

Anderson, W.I. (ed.), 1984. General Geology of north-central Iowa. Guidebook for the 48<sup>th</sup> Annual Tri-State Geol. Field Conf., 150 p.

Anderson, R.R., and Bunker, B.J. (eds.), 1998. Fossil shells, glacial wells, piggy smelts, and drainage wells: the geology of the Mason City, Iowa, area. Geol. Soc. of Iowa Guidebook No. 65, 171 p.

Belanski, C.H., 1927. The Shellrock Stage of the Devonian. American Midland Naturalist, v. 10, p. 316-370.

Belanski, C.H., 1928. The Shellrock Stage of the Devonian. American Midland Naturalist, v. 11, p. 165-212.

Bunker, B.J., and Highland, J.D., 1974. Soil Survey of Howard County, Iowa. U.S. Dept. of Agriculture, Soil Conservation Service, 195 p. with 79 map sheets.

Bunker, B.J., Witke, B.J., and Day, J.E., 1986. Upper Cedar Valley Stratigraphy, North-Central Iowa. Lithograph City Formation. Geol. Soc. of Iowa Guidebook No. 44, 41 p.

Bunker, B.J. (ed.), 1995. Geology and hydrogeology of Floyd-Mitchell counties, north-central Iowa. Geol. Soc. of Iowa Guidebook No. 62, 189 p.

Clark, R., Liu, H., Kerr, P., Tassier-Sartre, S., Rowden, R., and Streeter, M., 2016. Bedrock geologic map of Mitchell County, Iowa. Iowa Geological Survey Open File Map OFM-16-1.

Day, J., 2006. Overview of the Middle/Upper Devonian sea level history of the Wapsipinicon and Cedar Valley Groups, with discussion of new contour data from the subsurface Cedar Valley Group of southeastern Iowa. In Day, J., Laczaj, J., and Anderson, R. (eds.), New Perspectives and Advances in the Understanding of Lower and Middle Paleozoic Epicontinental Depositional Systems of the Iowa and Illinois Basins. Iowa Geological Survey Guidebook Series No. 25, p. 3-21.

Day, J., Witke, B., and Bunker, B.J., 2008. Overview of Middle and Upper Devonian Cedar Valley Group and Lime Creek Formation carbonate platform facies, faunas, and event stratigraphy of northern Iowa. In Groves, J.R., Walters, J.C., and Day, J. (eds.), Carbonate platform facies and faunas of the Middle and Upper Devonian Cedar Valley Group and Lime Creek Formation, northern Iowa. Iowa Geological Survey Guidebook No. 28, p. 13-39.

Day, J., Witke, B., and Lundy, S., 2013. Aspects of the Paleozoic history of epicontinuous sea of the Iowa Basin. Iowa Geological and Water Survey Guidebook No. 29, 118 p.

Groves, J.R., Walters, J.C., and Day, J. (eds.), 2008. Carbonate platform facies and faunas of the Middle and Upper Devonian Cedar Valley Group and Lime Creek Formation, northern Iowa. Iowa Geological Survey Guidebook No. 28, 96 p.

Kerr, P., Tassier-Sartre, S., Liu, H., and Clark, R., 2017. Surficial geologic map of the Colwell 7.5' Quadrangle, Floyd, Mitchell, Howard and Chickasaw counties, Iowa. Iowa Geological Survey Open File Map OFM-17-4.

Koch, D.L., 1970. Stratigraphy of the Upper Devonian Shell Rock Formation of north-central Iowa. Iowa Geological Survey Open File Report 10, 121 p.

Libra, R.D., Halberg, G.R., Rossmeyer, G.G., and Hoyer, R.E., 1984. Groundwater quality and hydrogeology of Devonian-Carboniferous aquifers in Floyd and Mitchell counties, Iowa. Iowa Geological Survey Open File Report 84-2, 1-106.

Libra, R.D., Quade, D.J., Halberg, G.R., and Link, J.P., 1994. Groundwater quality, hydrogeology, and agricultural drainage wells, Floyd and Mitchell counties, Iowa. Iowa Geological Survey Technical Information Series 25, 64 p.

Liu, H., McKay, R., Rowden, R., Quade, D., Tassier-Sartre, S., and Gaglianone, J., 2012. Bedrock Geology of Worth County, Iowa. Iowa Geological and Water Survey Open File Map OFM-12-1.

Liu, H., Clark, R., Fields, C., McKay, R., Rowden, R., Tassier-Sartre, S., Kerr, P., and Streeter, M., 2015. Bedrock Geology of Cerro Gordo County, Iowa. Iowa Geological Survey Open File Map OFM-15-1.

McKay, R.M., Liu, H., and Gaglianone, J.D., 2010. Bedrock Geology of Bremer County, Iowa. Iowa Geological and Water Survey Open File Map OFM-10-10.

McKay, R.M. & Liu, H., 2012. Cedar Valley Group: the Lithograph City - Shellrock Formation contact at Mason City, Iowa. Geol. Soc. of Iowa Guidebook No. 90, 12 p.

Moore, F., 1995. Floyd County groundwater protection project and sinkhole cleanup. In Bunker, B.J. (ed.), Geology and Hydrogeology of Floyd/Mitchell counties, north-central Iowa. Geol. Soc. of Iowa Guidebook No. 62, p. 75.

Prior, J.C., 1991. Landforms of Iowa. University of Iowa Press, Iowa City, 154 p.

Rowden, R., McKay, R., Liu, H., Quade, D., Tassier-Sartre, S., and Gaglianone, J., 2013. Bedrock Geology of Black Hawk County, Iowa. Iowa Geological and Water Survey Open File Map OFM-13-3.

Voy, K.D., 1995. Soil Survey of Floyd County, Iowa. U.S. Dept. of Agriculture, Soil Conservation Service, 260 p. with 63 map sheets.

Voy, K.D. and Highland, J.D., 1975. Soil Survey of Mitchell County, Iowa. U.S. Dept. of Agriculture, Soil Conservation Service, 125 p. with 70 map sheets.

Wilson, J.H., 1996. Soil Survey of Chickasaw County, Iowa. U.S. Dept. of Agriculture, Soil Conservation Service, 182 p. with 74 map sheets.

Witke, B.J. and Bunker, B.J., 1984. Devonian stratigraphy of north-central Iowa. Iowa Geological Survey Open File Report 84-2, p. 107-149.

Witke, B.J. and Bunker, B.J., 2006. Middle shelf facies of the Cedar Valley Group (Devonian) and their stratigraphic relationships in eastern Iowa. In Day, J.E., Laczaj, J., and Anderson, R. (eds.), New Perspectives and Advances in the Understanding of Lower and Middle Paleozoic Epicontinental Depositional Systems of Iowa and Illinois Basins. Iowa Geological Survey Guidebook Series No. 25, p. 23-40.

Witke, B.J., Anderson, R.R., and Pope, J.P., 2010. Bedrock geologic map of Iowa (1:500,000). Iowa Geological and Water Survey Open File Map OFM-10-1.

Witke, B.J., Bunker, B.J., and Rogers, F.S., 1988. Eifelian through lower Frasnian stratigraphy and deposition in the Iowa area, central midcontinent, U.S.A. In McMillan, N.J., Finley, A.E., and Glass, D.J. (eds.), Devonian of the World. Canadian Soc. of Petroleum Geologists, Memoir 14, vol. 1, p. 221-250.

**Lithology Key**

- Conglomerate
- Dolomitic limestone/calcitic dolomite
- Dolomite
- Limestone
- Fine grained sandstone
- Shale
- Lithographic limestone
- Breccia

**Symbol Key**

- Dolomitic
- Chert
- Sandy
- Shaly
- Stromatoporoids
- Unconformity
- Vugs

**Adjacent 7.5' Quadrangles**

NEW HAVEN	PIECEVILLE	SARATOGA
FLOYD	COLWELL	ELMA
CHARLES CITY	BASSETT	IOWA

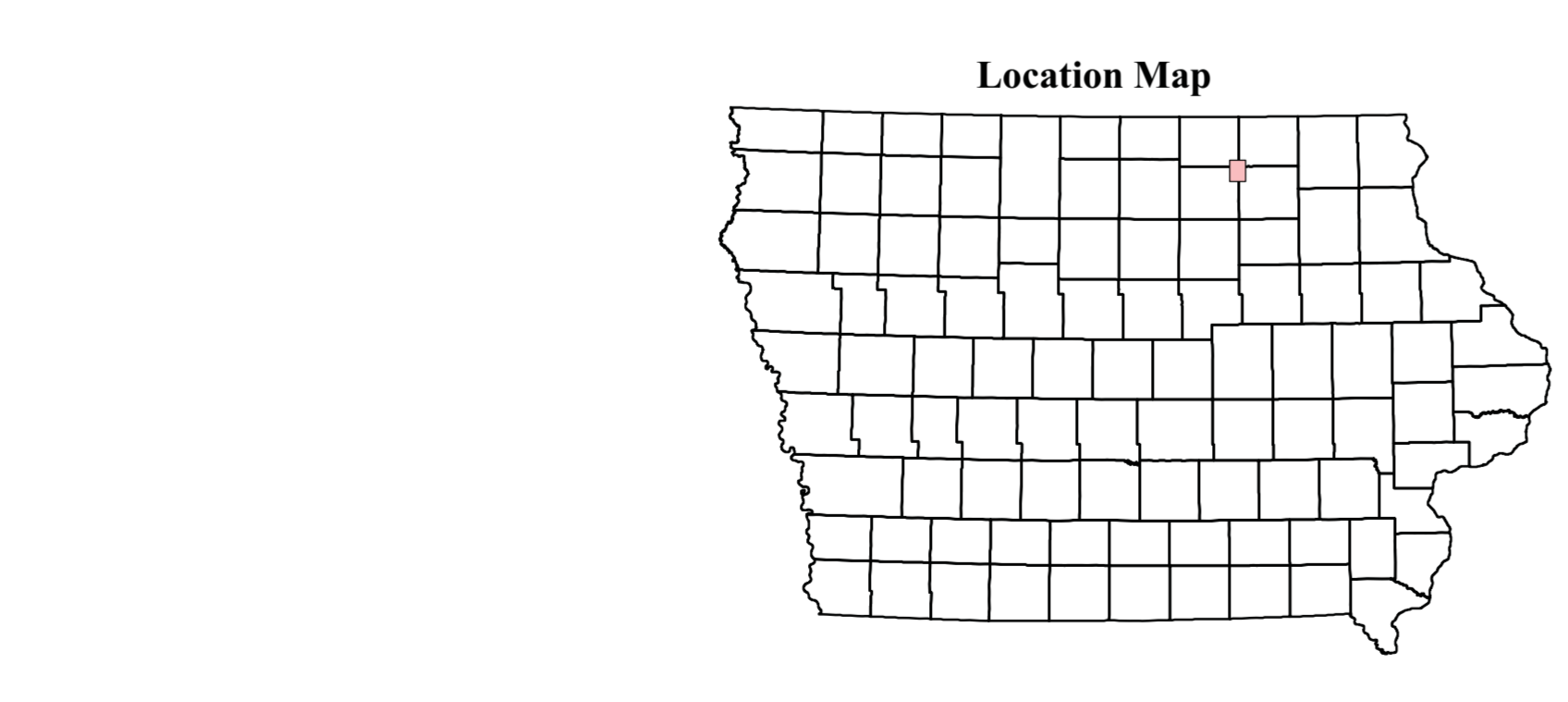

**GEOLOGIC CROSS-SECTION A-A'**

